

### Description

A compact and secure cam lock for furniture, industrial cabinets and electrical enclosures. The nylon housing is lightweight while remaining strong. Two keys are included as standard.

### Material

Nylon housing and zinc plated steel cam and screw

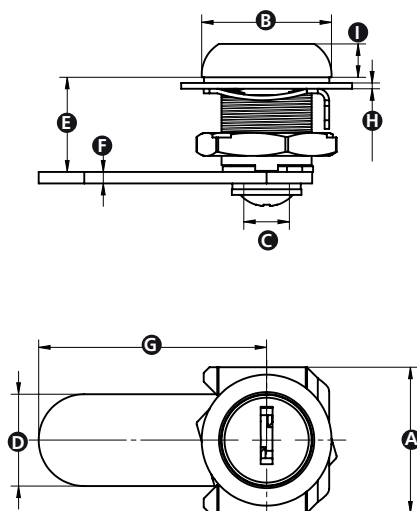

### Cut out

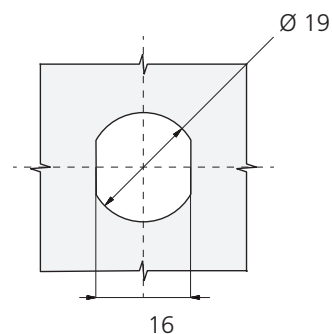

Part No.	A	B	C	D	E	F	G	H	I
16996T	25.4	22.8	8	16	16.5	2	40	1	5.8